

1/86 Volker Circuit Bahrs Scrub QLD

2  1  1 

A modern and low-maintenance 2 bedroom | 1 bathroom | 1 garage dual-key home, perfectly positioned in the growing Brookhaven Estate. Designed with high ceilings for extra openness and comfort, this property is ideal for singles, couples or small families looking for convenience, comfort, and easy access to the M1.

Type : Semi Detached

View : <https://www.kloverproperty.com.au/lease/qld/logan/bahrs-scrub/residential/semi-detached/8619419>

? Property Features

- ? Two well-sized bedrooms with built-in wardrobes
- ? Modern bathroom with quality finishes
- ? Contemporary kitchen with stainless-steel appliances
- ? Air-conditioned open-plan living and dining
- ? Single lock-up garage with internal access
- ? Private outdoor area, easy-care yard



Heather Lee
0472 504 548

[For full version visit the website](https://www.kloverproperty.com.au)

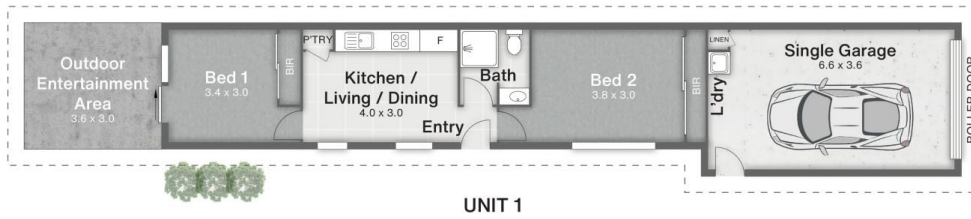
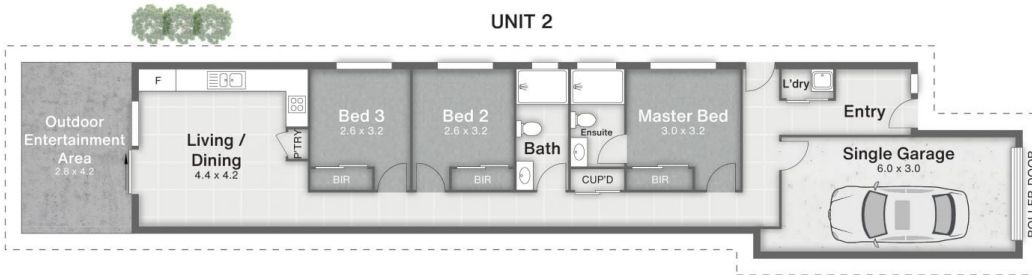

86 VOLKER CIRCUIT
 BAHRS SCRUB

194m²

458m²



←
 NORTH

Disclaimer

This is not a legal document; all measurements and dimensions are approximate and are subject to errors, omission or misstatement. No liability will be accepted. Plans are shown for marketing purposes only.