



2/86 Volker Circuit Bahrs Scrub QLD

3  2  1 

A spacious and modern 3 bedroom | 2 bathroom | 1 garage dual-key home located in the highly sought-after Brookhaven Estate. Designed with high ceilings for extra openness and comfort, this home is perfect for families or professionals wanting style and convenience.

Type : Semi Detached

View : <https://www.kloverproperty.com.au/lease/qld/logan/bahrs-scrub/residential/semi-detached/8619420>



Heather Lee
0472 504 548

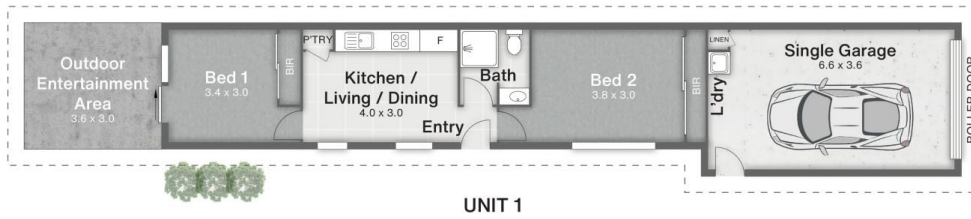
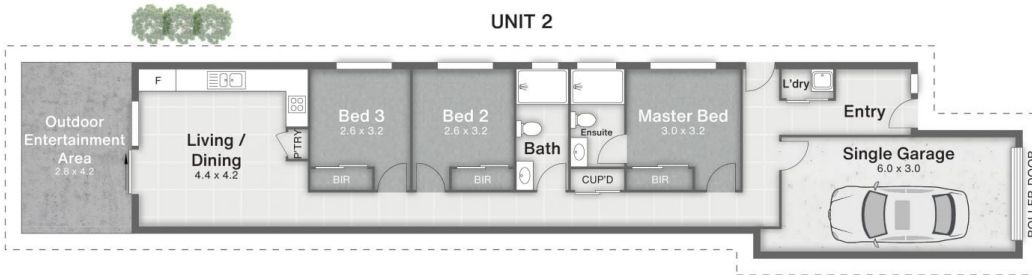

86 VOLKER CIRCUIT
 BAHRS SCRUB

194m²

458m²



←
 NORTH

Disclaimer

This is not a legal document; all measurements and dimensions are approximate and are subject to errors, omission or misstatement. No liability will be accepted. Plans are shown for marketing purposes only.