





220/85 Nottingham Road Calamvale QLD

3  **2**  **2** 

*The rent will increase from \$650 to \$680 effective 18 March.

Type : Townhouse

View : <https://www.kloverproperty.com.au/lease/qld/brisbane-region/calamvale/residential/townhouse/8619436>



Heather Lee
0472 504 548

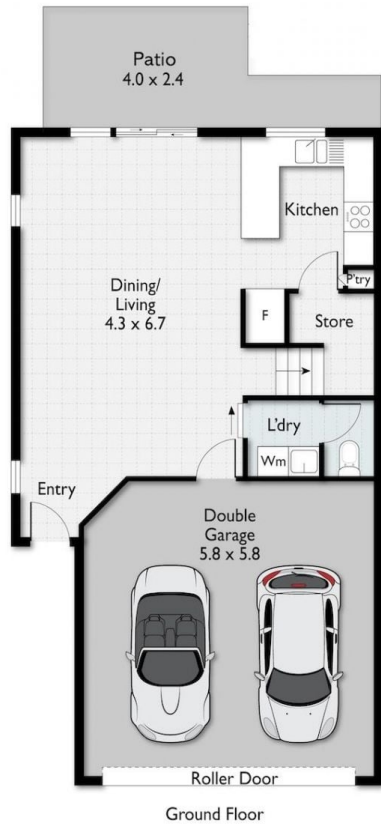

Ground Floor



First Floor

220-85 Nottingham Road, Calamvale

3 2 2 152m²