



260A Beaconsfield Terrace Brighton QLD

3  1  3 

Welcome to 260A Beaconsfield Terrace, Brighton - a spacious dual-level residence offering comfort, functionality, and a prime bayside lifestyle. Set on a 407m² block, this versatile home is perfect for families, professionals, and investors alike.

Type : House
Price : \$ 1,003,000
Building Size : 270 sqm
Land Size : 407 sqm
View : <https://www.kloverproperty.com.au/sale/qld/city-north/brighton/residential/house/8619555>



Kay Lee



Chris Shin

260A BEACONSFIELD TERRACE
BRIGHTON

 270m²

 407m²

 3  1  3



FIRST FLOOR

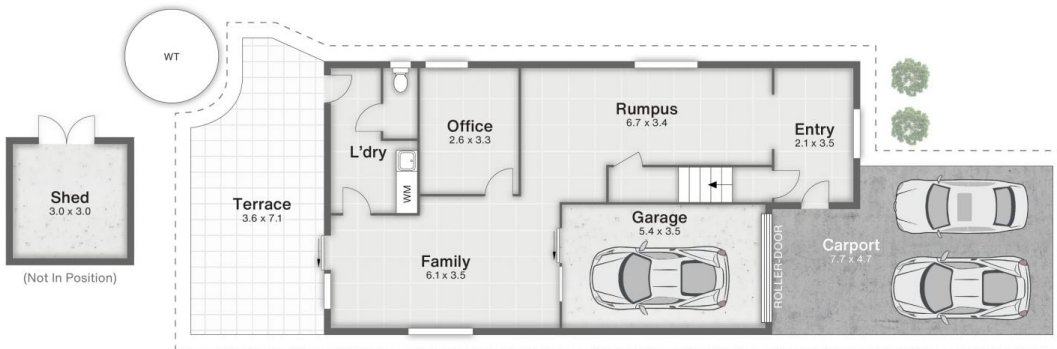

GROUND FLOOR



Disclaimer

This is not a legal document; all measurements and dimensions are approximate and are subject to errors, omission or misstatement. No liability will be accepted. Plans are shown for marketing purposes only.